

Putting your hearing aid in with anchor

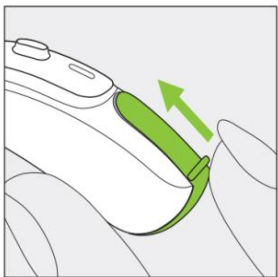

On

1. Switch the hearing aid on by closing the battery door.



2. Place the hearing aid behind your ear.

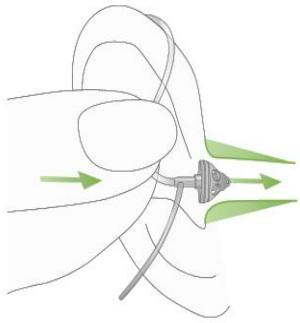

3. Use your thumb and forefinger to insert the tube into your ear canal. Insert the dome deep enough into the ear canal so that the tube lies flat on your ear.



4. Hold the anchor and place it into the bowl of your ear in order to retain the dome in the ear canal. If you have problems inserting the hearing aid, use your other hand to gently pull your earlobe downwards. This opens the ear canal a little more and you can rotate the dome until it fits correctly.



5. The anchor should be sitting into the bowl of your ear as demonstrated above.